



CONROD

February 2016

The Otago Model Engineering Society



CONROD is printed by:
Wickliffe Limited
11 Glenelg Street
Phone: 466 5100

Club Dates

Working Bee	10.00 am	First Saturday of the month
General Meeting	7.30 pm	Second Monday of the month
Boat Group	7.30 pm	First Wednesday following General Meeting
Engineering	7.30 pm	Third Monday of the Month
Scale Railway	7.30 pm	Each Tuesday
Thursday Toilers	9.30 am	Each Thursday
Committee Meeting	7.30 pm	Last Monday of the month
CONROD Deadline	12.00pm	Friday following Committee Meeting

1 John Wilson Drive, St Kilda, Dunedin, New Zealand
www.omes.org.nz
www.facebook.com/OtagoModelEngineering

PATRONS

Robert Storm
Graham Batts
Chris Staynes

Hon Solicitor

T.Whitcombe
todd@ond.co.nz

PRESIDENT

Michael Forrest
455 1642
gemi@slingshot.co.nz

SECRETARY

Michael O'Cain
488 2075
mikeocain@xtra.co.nz

TREASURER

Colin Nicholls
454-5432
colinn@clear.net.nz

COMMITTEE MEMBERS

Colin Downing
454 2528
Kevin Gamble
455 4547
Henry Goosselink
(Boat Group Leader)
488 3284
John Knight
(Scale Railway Leader)
476 6312
Stewart Robertson
021 1480683
Terry Smith
(Vice President)
454 5697
Allan Stevens
455 8665
Jim Woods
(Engineering Leader)
476 1369
Murray Wright
489 4218

Librarian

Brian Niven
bniven@maths.otago.ac.nz

Booking Officer

Terry Smith (V. P.)
terry.45.smith@gmail.com

Conrod Editors

Russell Clark
476 3663
Lachlan Clark
027 828 9809
conrod.omes@gmail.com

President Report

It's still January (but I've got the heater on in the study!) and a lot's happened already – an informal General Meeting, a Committee-Meeting, 2 parties booked (1 will have happened by the time you read this), work around the premises and of course preparations for Festival-Week. The informal meeting was preceded and followed by friendly chat in a good atmosphere; it went for only ¾ of an hour, with 18 men there, and concentrated on Festival-Week. The biggest job carried out at the club has been upgrading the tethered-car track, and already they're talking about 20km/h improvements in speeds.

A lot was dealt with at the Committee-Meeting. The Ocean Beach Railway chaps made quite a good interim repair to our shared fence, allaying OMES' concerns about its stability during Festival-Week. Murray Wright has replaced the cistern in the former ladies' (now unisex) toilet and is installing flash LED lighting in the stairwell; he intends extending this to the main corridor after the big event. Many thanks, Murray! Another matter deferred until then, because it needs General Meeting approval for the cost, is the replacement of 3 door-closers, on the 2 front doors and the one leading down into the electric-loco shed, to offset the force of the wind whipping them open or slamming them shut. One more working-bee by the Engineering-Group will see the outdoor-railway track-upgrade completed, with every bolt replaced. Grateful thanks to you folk, too!

A decision has been reached in regard to repowering the club electric locos. Two 24V 450W motors have been ordered from Australia along with a controller, a hand-piece and parts to adapt them to the existing set-up. Brian Niven has kindly offered his Class 08 chassis for use as a test-platform to allow this new equipment to be evaluated and if all works well another lot will be ordered so both club locos will have efficient up-to-date motors. A lot of research and discussion went into making this decision, especially involving Allan Stevens, Brian N, Craig MacDonell, Kevin Gamble, Lachlan Clark and Selwyn Benett – thanks a million, guys!



Please remember the AGM in March and give some thought to whom you want to see as President, Vice-President, Committee-Members etc, and to any changes you'd like to make to the Rules. Then get the nominations and notices-of-motion to the Secretary in time for the Committee-Meeting on 28th February.

Continues Over.....

Boiler Inspectors

Des Burrow
454 5565
Colin Downing
454 2528
Logan McGhie
476 1425
Allan Stevens
455 8665
Jim Woods
476 1369

Boiler Records

Geoff French
454 2171

Safety Group

Gary Douglas
476 7311
Chris Kennedy
466 7372
David McBride
476 1992
Stewart Robertson
021 1480683
Jim Woods
476 1369

The 80th anniversary celebration of OMES will be held on the week-end of the 16th and 17th April, subject to a minimum attendance of 25 Members. There's plenty of time yet but an indication of interest would be welcome so please contact your Group-Leader or a Committee-Member to let them know you'd like to participate in this.



Festival-Week is being covered elsewhere in this *Conrod* but I urge you to put as much time into it as you can spare, and also into the preparatory clean-up sessions on Tuesday and Wednesday evenings next week. The hall will be set up on Friday. Then it's all on from Saturday of Waitangi Week-end until the following Sunday. Lots of models are needed, especially old, partly built, or unusual ones. Note that there will not be a General Meeting this month. See you during Festival-Week.

Michael Forrest

Editors Desk

This last month has been a busy one at the club with preparations coming together ahead of Festival Week. As the following pages can attest, each group has been putting in a great effort to ensure all is ready for our biggest event of the year. All we need now is for some good weather, and for the public and our members to show up in force! This years Festival Week is taking a reflective view on the clubs 80 year history. Looking over the photos published in the 'Archive' section of *Conrod* (and those I am yet to publish) it is clear to see we have come along way and that the spirit of mucking in and getting things done is still alive and well at OMES. On this note I must also highlight the clubs 80th celebrations in April. Please see all the information regarding this in the 'Notice Board' section on page 5. All members, affiliated club members, past members, partners, and family welcome.

While we are looking ahead, it pays to remember the AGM in March. See page 10 for more details from Mike O'Cain.



In the last month Dunedin has hosted a vintage car rally which coincided with the *Wings and Wheels* event at Taieri Airport. *Wings and Wheels* was well attended by members and others alike who enjoyed a large collection of old cars, planes and helicopters. I think I saw more members at this event than we get at a General Meeting! On Tuesday the 19th OMES hosted owners of Woolsley, Rover, and Riely vehicles ahead of their excursion to Waihola.

This months *Conrod* is coming from a bit further afield. I have taken a job in Wellington, working for FMG Insurance. Plane tickets are booked for Dunedin for Waitangi weekend, and I hope to see you all at the club!

Lachlan Clark

From the Archives



Notice Board

Walked Track Inspection

Reminder: Before **every event** day controllers **must** do a **walk** around of the track!

Festival Week

Time and Date

- 6th to 14th of Feb
- 10.30 - 4.30 (Weekend + Waitangi)
- 6.30 - 8.30 (Week excluding Waitangi)



There are still some vacancies on the roster. Please fill it in if you can help.

Working Bee

- A general tidy up of the grounds
- Tuesday 2nd and Wednesday 3rd of Feb
- 6.30 pm onwards



Theme / Hall

- Models at different stages of construction
- Models from different eras
- Need the hall to be chocker
- Models of other things like tools and pumps
- Items we haven't seen in a long time
- Setup Friday 5th. Please bring along models as early as possible after 10am

On the day

- Please register with Ken at the tower
- Lunches are also available to order from Ken (Cost \$5)





Chris demonstrating the Jim Woods driving style! ;)

OMES 80th Weekend

-16th and 17th of April

-Saturday:

Light Lunch (Similar to Festival Week)),
Running Afternoon and Evening
Meal (Similar to the OMES Christmas
Dinner on the 19/12/2015)

-Sunday:

BBQ Lunch, Running Afternoon

-To make this viable we need at least 25
people

-All members, affiliated club members, past members, and family welcome.

-Cost of \$40 will cover the weekend

-RSVP to Colin: 454 2528 or downings@hyper.net.nz before 1st of April

-Money payable at the April General Meeting.

Taieri Gorge Rail Walk

-1st May 2016

-Photo [Daily Telegraph](#)



Get a group of friends or colleagues together and join us for a unique opportunity to walk along the spectacular Taieri Gorge rail line. Leave by train from Dunedin Railway Station at 8:30am then walk from Flat Stream to Machine Creek

(8km) taking in two tunnels, four bridges and viaducts along the way. Enjoy a sausage sizzle barbeque before returning to Dunedin by train. Not only is this event a once in a lifetime experience, all proceeds after costs will be donated to Presbyterian Support Otago. Funds raised will be used to purchase outdoor equipment and trailer for use in our youth programmes.

- The buffet car will be open.
- Essential equipment includes suitable walking shoes, all-weather clothing, a good torch, water and snacks.
- Not suitable for children.
- \$59 per person. Tickets available online (+ booking fee), or at Dunedin Railway Station. Price includes sausage sizzle barbeque.
- <https://www.facebook.com/events/588690177949157/>

This event has been made possible through the generosity of the Lions Club of Dunedin South. Presbyterian Support Otago is very grateful for the Club's support in hosting this wonderful event for the benefit of young people in Otago.

Bookings

Date	Time	# Attn	Event
30th January	10.00 - 12.00	12	Birthday Party
20th February		12	Birthday Party





Scale Railway

Hi all, and I hope that the new year will treat you all well.

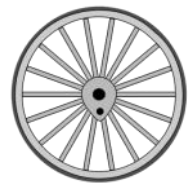

Our meeting started off with problems relating to a DCC fault on the OO/HO layout. Thought we had a dead DCC command unit, but no. The fault was cleared by unplugging everything, then reconnecting. Our roster for festival week has been sorted, and the display cabinet will be filled with older models and models under construction.

Selwyn Bennett brought along an NZ flag (fullsize, so not suitable for model railway!), and a small air compressor (with pressure gauge) he purchased at a local automotive shop for \$65. A neat unit. He also displayed a LED strip which could be suitable for carriage lighting, but was overly bright on test. That may be able to be altered. John Knight noted that similar LED strips are available which are programmable for colour, which may have application for “theatrical” lighting effects on layouts (thunder and lightning etc?)

Geoff Murray displayed a Bachmann Scenecraft farm house to go with his “farm barn” reported in an earlier Conrod. A nice and finely detailed model.

Murray Gibb had been building a small canal barge for his OO layout. He used a kit, downloaded Scalescenes (scalescenes.com), which allows the boat to be built from card, layered for 3D effect, and overlaid with a coloured drawing paper veneer. It will look good on Murray’s layout when finished with locks etc.

Stuart Reid reported that he was sorting out a mechanism for an Alexandra-style clock to go on the hill at the rear left of the OO/HO layout. He said he has previously made clocks that go backwards, so I hope he gets this one right! He also showed some parts for a working trampoline he is designing for the N scale layout. Its likely to use a motorised cam system to produce the up/down action needed. He had also bought some Prieser HO “cameramen” to be used in animation of his motor bike layout seen at our train show last year.

Continues Over.....

Giam gave us a rundown on a Shay loco he had bought on ebay. Since it wasn't working satisfactorily when received, he has rebuilt the model, added more detail from the junkbox and repainted it. Its another creditable job from Giam, but he notes that it still "waddles" along the track when running due to bogie modifications made by the previous owner. At a scale speed of 19mph it takes 17mins to complete a lap of the OO layout.



John Knight described how he is working out how he is going to wire a layout for a friend. It's a Hornby set track layout design of a double main circle plus two passing loops and some sidings, to be run by two DC controllers. He used the Paint program to draw a simplified track layout, then coloured in sections of the layout corresponding to those needing separate electrical feeds. This allowed the design to incorporate some crafty switching to be able to run both main lines, while doing some shunting in the sidings, from the two controllers.

Brian Niven



Boating Group Report

Our running night on Wednesday 13th January turned out to be a non-event owing to a very cold evening with only eight members turning up. The consensus was that it would be warmer upstairs, so that is where we went.

Bits on the Table and Workshop

Stuart Reid had brought along a brushless fan unit approx 75mm in diameter that he had purchased from Hobby King China. He intends to mount it on an air boat hull giving the craft a very low centre of gravity. This led to a discussion of LiPo batteries. These are best obtained from the Hobby King site in Australia, rather than direct from China. They are shipped surface mail from Australia as owing to their construction, i.e. plastic explosives, they cannot be shipped by air. There is also a free postage delivery option for some items. If you are interested in this and intend to import from overseas, check with Stuart as to the details.

Continues Over.....

Kevin Gamble had the signage and waterline marking done professionally on his fishing boat. We will now have to ask Murray to stock the pond as several members have fishing boats. Kevin had also been working on a water skier; an idea he found in a recent copy of Model Boats. So far I have seen the mark 1, 2 & 3 versions with the mark 2 looking the most promising at this stage. He also showed us a copy of the Otago Harbour ferry "Golden Age". This paddle steamer was the first ferry on the harbour to go from Dunedin to Portobello. He had found the Hocken Library and staff most helpful in obtaining photos and information in order to build the model. He had previously been to the Port Chalmers Maritime Museum. and obtained the overall length, beam and draught of the ferry.

Midweek Boating

The midweek boating group have been more successful with running sessions on the pond with temperature of between 18 and 22 °C and have had several outing on the pond since our last meeting in December. The pond is at present very low and it is proposed to make a removable jetty at a lower level to more easily launch and retrieve the boats.

Festival Week

When you receive this Conrod we will be very close to festival week, so will see you all there. And, don't forget to put your name on the roster on the passage way notice board. It's never too late.

Henry Goosselink

Photos: John Anderson



Engineering Group

February Newsletter huh? Soon be AGM time!

So our first meeting for 2016 was a nice quiet affair, about 15 members present. After a quick discussion on the coming annual display, thoughts then turned to the outside area and the railway.



Bits on the table where Des' latest huge boiler, a 3 ½ Tich for Dave McBride under test.

Also on the table was Mel's Christmas present from Chris. An "0" gauge GWR region 15xx pannier tank, also known as Speedy in 5 inch gauge. Found on Trademe with a few wee issues. Mary has said that this one will be allowed in the lounge

We nearly got the bolt replacement finished the Saturday after the meeting. However the track continues to offer surprises. Bolts we thought were OK aren't and those that looked dodgy are OK. This means that all bolts need to be removed, inspected and replaced. A huge clean out of the steam shed was also carried out and about ½ a skip of old stuff was thrown out. We may need to weigh it down now to stop it blowing away. Many thanks to the usual guys that showed up and a special mention to Keith Murphy too. Nice to see the old ways of helping each other back.

Festival Week is all go. Engineering group and the others who pitched in have done a grand job of picking up the pieces at a very late stage and nailing together something that, in the long run, benefits the whole club.

OK, that's nearly all from me. Time to polish the models ready for the display. Let's all fill the hall with models both old and new and show the public what real model engineering is about, building great stuff not just trains!

Jim Woods

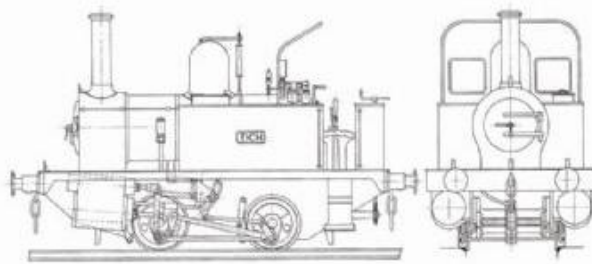

From the Committee

Notice of 2016 Annual General Meeting

The 2016 Annual General Meeting of the Society will be held at the Society club-rooms on 14th March 2016 at 7-30pm.

1. As per the Society Rules the following must be re-elected –President, Vice President, Secretary, Treasurer and three members of the Committee. Committee members stepping down are: Colin Downing, Stewart Robertson and Kevin Gamble. (These members can stand again if nominated)
2. Nominations for all positions to be with the secretary by 5.00pm 28th February 2016. Each nomination is to be on the Official Nomination Form, clearly stating the nominee, position sought, proposer, seconder, and signed by the nominee. Forms are available on the club notice board or from the secretary.
3. Any motions, proposed alterations to the Society’s Rules or other business for the meeting are to be with the Secretary by 5.00pm 28th February 2016. The motion etc must be complete and included the name of the proposer and the seconder.

A preliminary agenda, and the unconfirmed minutes from the 2015 AGM are on the notice board and in the library. The Agenda for the meeting will be available shortly after the Committee meeting on the 28th February.

Signed: Mike O’Cain (Secretary)

	<p>Otago Model Engineering Society Annual General Meeting - March 2016 Nomination Form</p>
Nominee	
Position	
Proposer	
Secunder	
Acceptance of Nomination	Signature:

To be with the Secretary by
5.00pm 18th February





Otago Model Engineering Society Festival Week



Train Rides - Model Boats - Tether Cars - Scale Railway

February 6th to February 14th
Weekends and Waitangi Day 10.30 to 4.30
Weeknights 6.30 to 8.30

www.omes.org.nz

1 John Wilson Drive, St Kilda

Sorry no EFTPOS

**Health and Safety
Report**
Source: Funny Junk



**Otago Model
Engineering Society**

«**First Name**» «**Last Name**»

«**Street**»

«**Suburb**»

«**Town** »

«**Post Code**»

CONROD

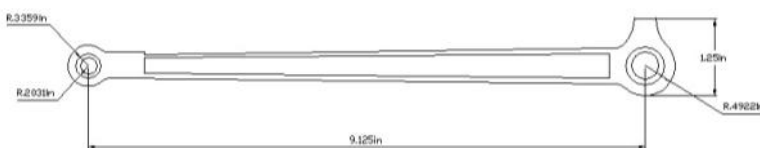

Sender:

Otago Model Engineering Society
1 John Wilson Drive

P.O. BOX 2163
South Dunedin